

REV.	DATE	ECR NO.	DESCRIPTION
NC	01/24/11	--	INITIAL RELEASE
A	04/20/11	2161	CHANGE THE CONTACT LENGTH TO .500" FROM .455"

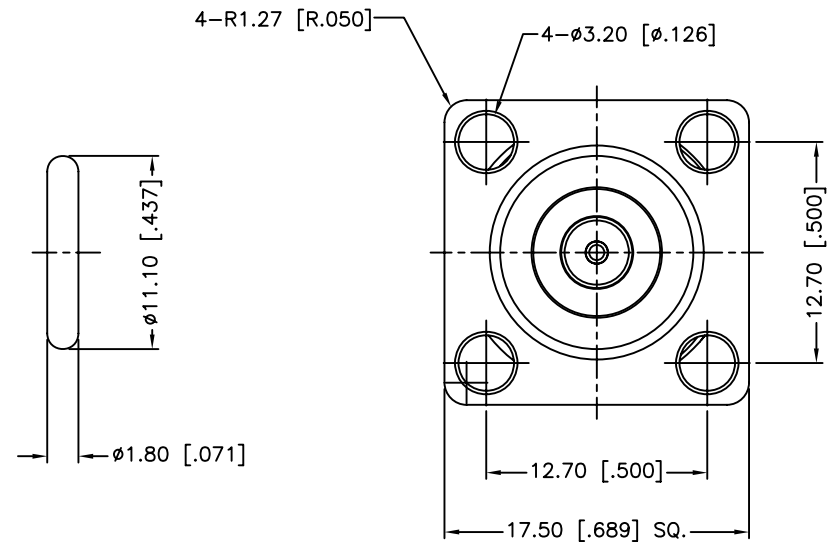
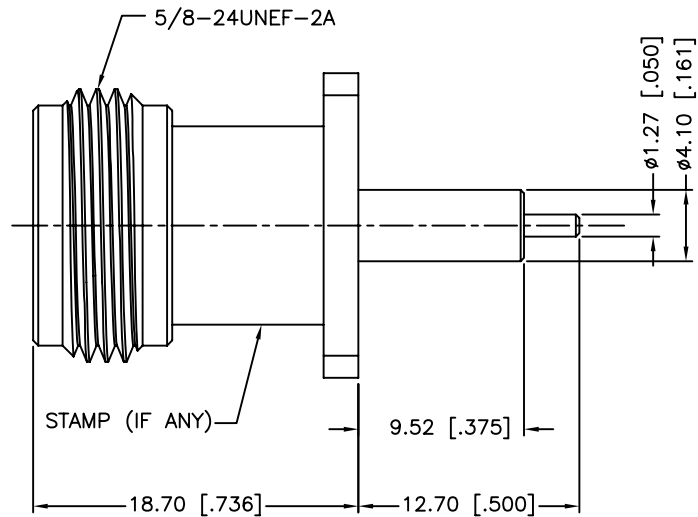

4	GASKET	SILICONE	RED	1
3	CONTACT PIN	PHOSPHOR BRONZE	GOLD	1
2	INSULATOR	PTFE	NATURAL	1
1	BODY	BRASS	NEXCOTE	1
	DESCRIPTION	MATERIAL	FINISH	QTY

UNLESS OTHERWISE SPECIFIED DIMENSIONS ARE IN MILLIMETERS. DIMENSIONS IN [] ARE IN INCHES AND FOR CUSTOMER REFERENCE ONLY.
UNLESS OTHERWISE SPECIFIED TOLERANCES FOR MILLIMETERS ARE: 0.5 - 8mm ± 0.20mm 8 - 30mm ± 0.40mm 30 - 120mm ± 0.50mm
UNLESS OTHERWISE SPECIFIED TOLERANCES FOR INCHES ARE: .020 - .315 ± 0.007" .315 - 1.180 ± 0.015" 1.180 - 4.724 ± 0.020"
DO NOT SCALE DRAWING

APPROVALS	DATE
DRAWN M.ZHANG	04/20/11
CHECKED	
ISSUED	
SHEET 1 OF 1	
CAD FILE C:/CONNEX/172224-24.DWG	

Amphenol Connex			
PART DESCRIPTION N PANEL RECEPT. JACK EXTENDED TEFLON/CONTACT (.375"/.500")			
PART NO. 172224-24			
DWG. NO. 172224-24.DWG	REV. NC	SIZE A	SCALE NA

Mouser Electronics

Authorized Distributor

Click to View Pricing, Inventory, Delivery & Lifecycle Information:

[Amphenol:](#)

[172224-24](#)